



**HB.160**

## WARRANTY INFORMATION

### FRAME

HB.160 Warranty strictly applies to the original owner who has registered the bike with Datatag. Hope Technology will repair or replace at its discretion any frame it determines to be defective. Any modifications to the original configuration of the frame will void the Warranty. This includes angleset components, painting and other such modifications. The Warranty does not cover consumable parts such as brake pads, rims and tyres unless deemed to be faulty, at the discretion of Hope Technology.

### FRAME BEARING

HB.160 frame bearings are warranted for life of the original owner. The frame bearings must be fitted by either Hope Technology or a registered HB dealer.

### HOPE COMPONENTS

Hope cycle components are warranted for a period of two years from purchase, to the original owner (excluding frame and bearings). All other Hope Technology components Hope Technology cycle components (excluding the frame, bearings and carbon handlebars) are warranted for a period of two years from purchase, to the original customer.

### NON-WARRANTY PARTS

If any part of the bike is damaged or lost, Hope can offer a replacement at a reduced charge, at their discretion.

### WARRANTY CLAIMS

Please visit the service and warranty page on [hopetech.com](http://hopetech.com) and fill out the misc. warranty claims form and return to Hope Technology.



Sales enquires: [orders@hopetech.com](mailto:orders@hopetech.com)  
Technical and demo bike information [doddy@hopetech.com](mailto:doddy@hopetech.com)

## HB.160 LIMITED LIFETIME WARRANTY

HB.160 bikes purchased from an authorised HB.160 dealer are warranted by Hope Technology (IPCO) Ltd to be free from defects in material and workmanship under normal use for the lifetime of the product so long as the original owner owns the complete bicycle, please note this is the lifetime of the product, not your lifetime, your HB.160 may not live until the ripe old age of 80 (although we do know of some original well cared for lightweight hubs from 1991 still going strong!)

All Hope Components on HB.160 complete bicycles purchased from an authorised HB.160 dealer are warranted by Hope Technology (IPCO) Ltd to be free from defects in materials and workmanship under normal use for two (2) years from date of purchase. This excludes normal wear items, including but not limited to brake housing, brake pads, rims and cassettes, this warranty excludes parts damaged resulting from a crash, fall or other accident.

All original parts on HB.160 complete bicycles are warranted by Hope Technology (IPCO) Ltd to be free from defects in materials and workmanship under normal use for one (1) year from date of purchase. This excludes normal wear items, including but not limited to tires, tubes, shift housing, and chains, this warranty excludes parts damaged resulting from a crash, fall or other accident. HB.160 Frame bearings are warranted for the lifetime of the product, frame bearings will be provided to and fitted by an authorised HB.160 dealer or Hope Technology, labour charges are not covered by this warranty.

During the warranty period, all original parts and bicycle frames subject to this limited warranty and determined by an authorised HB.160 dealer to be defective in material or workmanship will be repaired or replaced by Hope Technology (IPCO) Ltd, through an authorised HB.160 dealer, free of charge, except for shipping or other transportation charges and dealer labour charges which are not covered by this limited warranty. This limited warranty applies only to HB160 complete bicycles which were fully assembled by an authorised HB.160 dealer at the time of purchase and were not altered in any way inconsistent with the bicycles design. In order to obtain lifetime limited warranty service, the bicycle, together with the bill of sale and assembly, must be presented to the authorised HB160 dealer.

**NOTICE:** The user assumes the risk of any personal injuries, damage to, or failure of the bicycle and other losses if HB.160 bicycles are used in any competitive event (including bicycle racing, dirt bike jumping, freestyle riding or other similar activities or training for such activities), altered in any way inconsistent with the bicycles originally designed purpose, used for stunt riding, to tow another person or vehicle, used with motors or any power driven apparatus. Any of the foregoing will invalidate the limited lifetime warranty and Hope Technology (IPCO) Ltd shall not be liable for any failure, loss, damage or injury resulting from such uses or alterations. This limited warranty does not cover any personal injuries, damages to or failure of the bicycle or any other losses due to accident, misuse, alteration, neglect, abuse, normal wear and tear, improper assembly, improper fit, improper maintenance, or use of unauthorised replacement parts or parts not specifically designed for the bicycle. This limited warranty is the only warranty applicable to HB.160 bikes and is expressly in lieu of any other warranty. Any implied warranty, including any warranty of merchantability of fitness for a particular purpose, is limited in duration to the duration of this express warranty. This limited warranty gives you specific legal rights and you may also have other rights, which may vary by region or country.

**NOTE:** Warranty not valid unless registered with DATATAG.



Sales enquires: [orders@hopetech.com](mailto:orders@hopetech.com)

Technical and demo bike information [doddy@hopetech.com](mailto:doddy@hopetech.com)

## SPARES LIST\_2018

PART	DESCRIPTION	PART NUMBER	QUANTITY	COLOUR OPTION	
FRAME BEARING KIT	Bearing 24x12x6	61901	2	NO	
	Bearing 17x26	61803	4	NO	
	Bearing 17x28	17287	4	NO	
BOLT KIT	Rocker axle female	HB101-109	1	YES	
	Rocker axle male	HB101-108	1	YES	
	Spacers 12x21x3	HB101-49	2	NO	
	Seatstay axle	HB101-110	1	YES	
	Chainstay/Seatstay bolt	HB101-106	1	YES	
	Circlip	XVHM-28	2	NO	
	Spacers 17x24x3	HB101-13	2	NO	
	Chainstay Axle	HB101-53	1	YES	
	Chainstay/Seatstay bolt	HB101-106	1	YES	
	Spacers 17x24x3	HB101-13	2	NO	
	Horst link bolt	HB101-18	2	YES	
	Spacer 17x24x3	HB101-13	4	NO	
	Spacer 17x20x2	HB101-19	2	NO	
	REAR AXLE KIT	Rear wheel axle	HB101-88	1	YES
		Rear wheel axle Nut	HB101-25	1	YES
M4x12 bolt		M412	1	NO	
BOTTOM BRACKET KIT	NDS BB insert	HB101-20	1	NO	
	DS BB insert	HB101-21	1	NO	
	Bearing shield	HB101-22	2	NO	
	Bearing 30x42x7	S71806	2	NO	
HANGER	Rear mech hanger	HB101-24	1	NO	
SHOCK BOLT KIT	Shock eye M8 bolt	HB101-46	2	NO	
REAR BRAKE MOUNT160	Radial mount 10mm spacers	HBSP375	2	NO	
	M6x30 Bolts	M630	2	NO	

Please place your order with sales – full kits containing the parts listed in each section will be available soon – this sheet will be updated when they are created.



Sales enquires: [orders@hopetech.com](mailto:orders@hopetech.com)  
 Technical and demo bike information [doddy@hopetech.com](mailto:doddy@hopetech.com)

## SPARES LIST\_2018

PART	DESCRIPTION	PART NUMBER	QUANTITY	COLOUR OPTION
REAR BRAKE MOUNT 180	Radial mount 10mm spacers	HB375	2	NO
	M6x35 Bolt	M635	2	NO
CHAIN GUIDE KIT	Front cage	HCG009-03	1	NO
	Rear Cage	HCG009-02	1	NO
	Backplate	HB101-84	1	NO
	2.5 Spacers black	DTSP102-36	3	NO
	M5x12 cap screw	M512SS	2	NO
	M5x14 cap screw	M514SS	1	NO
MAIN FRAME PARTS	Front triangle SMALL	HB160-CFT-S	1	NO
	Front triangle MEDIUM	HB160-CFT-M	1	NO
	Front triangle LARGE	HB160-CFT-L	1	NO
	Front triangle X-LARGE	HB160-CFT-XL	1	NO
REAR TRIANGLE	Seatstay assembly	HB160-SSTA	1	NO
	Chainstay assembly	HB160-CSA	1	NO
REAR HUB BEARING KIT	20x32x7 Bearing	S6804	2	NO
	17x28x7 Stainless bearing	17287	2	NO
REAR HUB END SPACER KIT	Drive Side Spacer	HUB1013-02	1	NO
	Non Drive Side Spacer	HUB1013-03	1	NO
SHIMANO/SRAM D/S FREEHUB SPACER	Rear Hub DS Spacer Shimano/Sram Black	HUB1013-01N	1	NO

Please place your order with sales – full kits containing the parts listed in each section will be available soon – this sheet will be updated when they are created.



Sales enquires: [orders@hopetech.com](mailto:orders@hopetech.com)  
 Technical and demo bike information [doddy@hopetech.com](mailto:doddy@hopetech.com)

## FRAME ASSEMBLY

Rocker  
HB101-42

12x21x3 Spacer (x2)  
HB101-49

12x24x6 Bearing (x2)  
61901

Rocker axle female  
HB101-109

17x24x3 Spacer (x2)  
HB101-13

Chainstay/Seatstay bolt  
HB101-106

BB Bearing shield (x2)  
HB101-22

BB Bearing (x2)  
30x42x7

Horst link bolt (x2)  
HB101-18

Rear wheel spindle  
HB101-88

17x24x3 Spacer (x4)  
HB101-13

17x20x2 Spacer (x2)  
HB101-19

17x26x5 Bearing (x4)

Mech hanger  
HB101-24

Rear spindle nut  
HB101-25

Chainstay/Seatstay bolt  
HB101-106

17x28x7 Bearing (x2)

17x24x3  
Spacer (x2)  
HB101-13

Seatstay  
subassembly  
HB160-SSSTA

NDS BB Insert  
HB101-20

M4x12

Front Triangle assembly  
HB160-FTA

Rocker axle male  
HB101-108

Circlip (x2)  
XVHM-28

Seatstay axle  
HB101-110

Shock eye M8 bolt (x2)  
HB101-46

17x28x7 Bearing (x2)

Chainstay axle  
HB101-53

Slick chainguide  
HCG009

DS BB Insert  
HB101-21

Chainstay subassembly  
HB160-CSA

## TORQUE SETTINGS

**BONDED CUPS**  
DO NOT REMOVE

**Horst link pivot**  
25 N.m

**Rear wheel spindle**  
30 - 35 N.m

**Mech hanger bolt**  
3 N.m

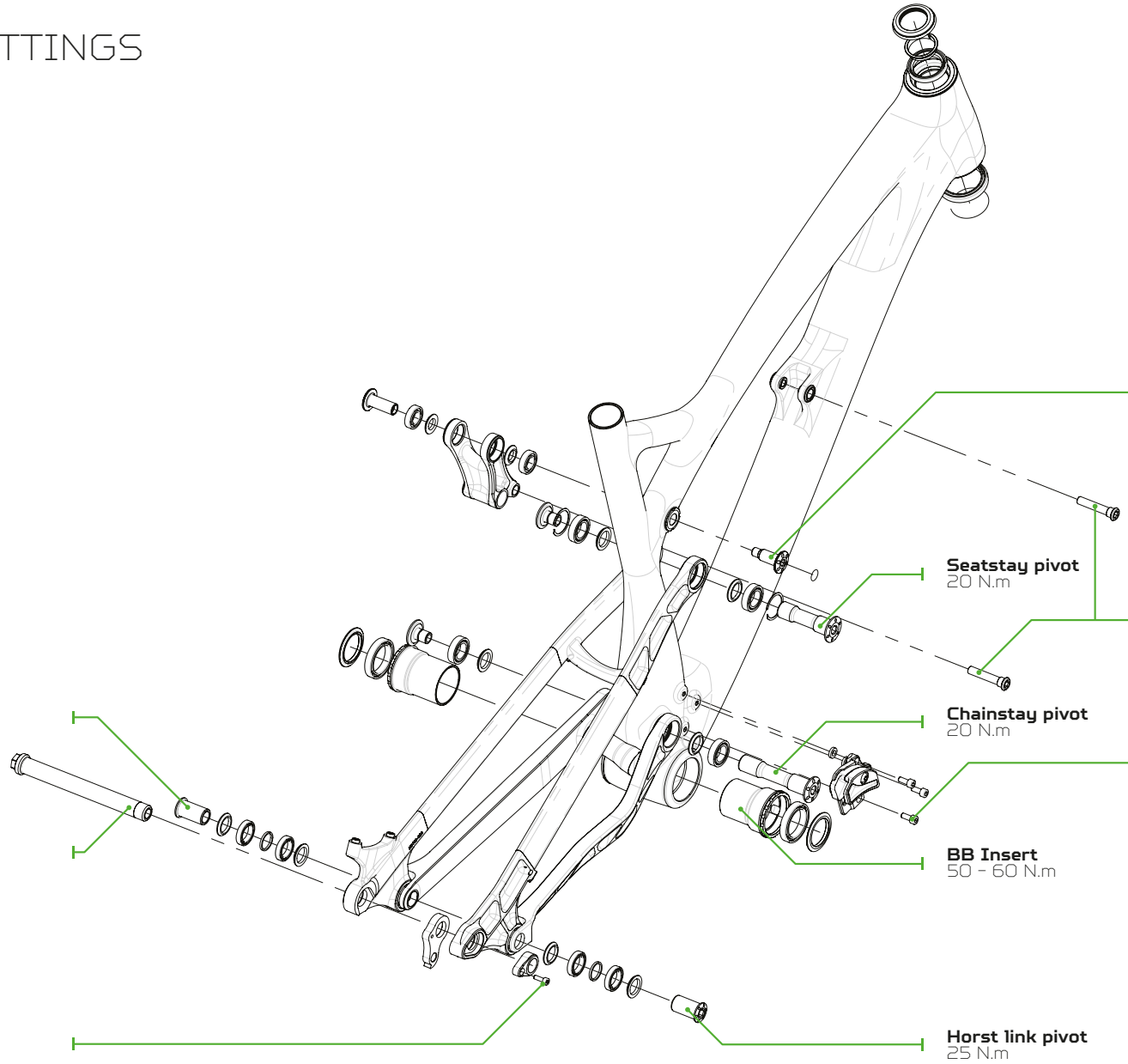

**Rocker pivot**  
17 N.m

**Seatstay pivot**  
20 N.m

**Rear shock bolts**  
17 N.m

**Chainstay pivot**  
20 N.m

**Chainguide bolts**  
5 N.m

**BB Insert**  
50 - 60 N.m

**Horst link pivot**  
25 N.m